

Réducteur GP 32 S Ø32 mm, vis métrique

screw drive

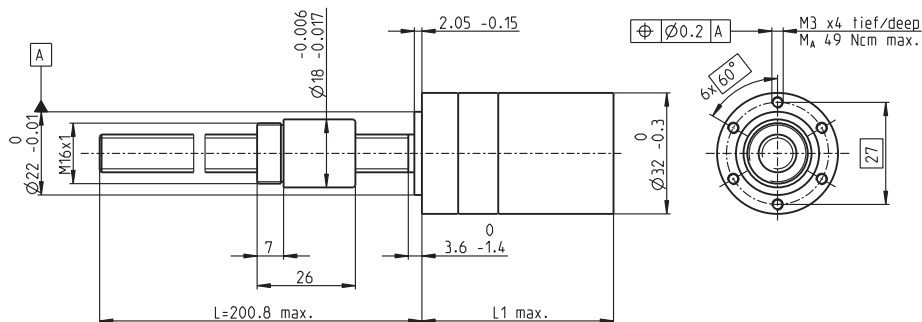

Données techniques

| | |
|---|-------------------------------------|
| Vis | M10 x 1, acier inoxydable |
| Longueur standard | 200.8 mm |
| Longueurs spéciales (par pas de 5 mm) | max. 600 mm |
| Écrou (standard) | écrou fileté |
| Matériau | bronze |
| Jeu axial | < 0.008 mm |
| Réducteur planétaire | à denture droite |
| Paliers | roulement à billes/butée à rouleaux |
| Jeu radial à 5 mm de la face | < 0.05 mm |
| Jeu axial | pré-contraint |
| Vitesse d'entrée permanente max. ² | 8000 tr/min |
| Plage de température recommandée | -15...+80°C |
| Charge axiale max. (statique) ¹ | 2700 N |
| Nombre d'étages | 0 1 2 3 4 |
| Charge radiale max. à 15 mm de la face | 200 N 200 N 350 N 400 N 400 N |

M 1:2

| | | Numéros d'article | | | | | | | | | |
|---|------------------|-------------------|--------|--------|--------|-----------|-----------|-------------|------------|------------|--|
| | | 363900 | 363901 | 363904 | 363909 | 363910 | 363915 | 363920 | 363925 | 363930 | |
| Données entraînement vis/écrou | | | | | | | | | | | |
| 1 Rapport de réduction | | 1:1 | 3.7:1 | 14:1 | 33:1 | 51:1 | 111:1 | 246:1 | 492:1 | 762:1 | |
| 2 Rapport de réduction exact | | 1/1 | 26/7 | 676/49 | 529/16 | 17576/343 | 13824/125 | 421824/1715 | 86112/175 | 19044/25 | |
| 20 Vitesse d'avance max. ¹ | mm/s | 100 | 36 | 9.5 | 4.0 | 2.6 | 1.2 | 0.5 | 0.3 | 0.2 | |
| 21 Force d'avance max. (permanente) ¹ | N | 183 | 257 | 400 | 533 | 616 | 798 | 1040 | 1311 | 1350 | |
| 22 Force d'avance max. (intermittente) ¹ | N | 455 | 638 | 995 | 1324 | 1350 | 1350 | 1350 | 1350 | 1350 | |
| Numéros d'article | | | | | | | | | | | |
| 1 Rapport de réduction | | | 4.8:1 | 18:1 | | 66:1 | 123:1 | 295:1 | 531:1 | 913:1 | |
| 2 Rapport de réduction exact | | | 24/5 | 624/35 | | 16224/245 | 6877/56 | 101062/343 | 331776/625 | 36501/40 | |
| 20 Vitesse d'avance max. ¹ | mm/s | | 28 | 7.4 | | 2.0 | 1.1 | 0.5 | 0.3 | 0.1 | |
| 21 Force d'avance max. (permanente) ¹ | N | | 280 | 435 | | 671 | 826 | 1105 | 1345 | 1350 | |
| 22 Force d'avance max. (intermittente) ¹ | N | | 696 | 1082 | | 1350 | 1350 | 1350 | 1350 | 1350 | |
| Numéros d'article | | | | | | | | | | | |
| 1 Rapport de réduction | | | 5.8:1 | 21:1 | | 79:1 | 132:1 | 318:1 | 589:1 | 1093:1 | |
| 2 Rapport de réduction exact | | | 23/4 | 299/14 | | 3887/49 | 3312/25 | 389376/1225 | 20631/35 | 279841/256 | |
| 20 Vitesse d'avance max. ¹ | mm/s | | 23 | 6.3 | | 1.7 | 1.0 | 0.4 | 0.2 | 0.1 | |
| 21 Force d'avance max. (permanente) ¹ | N | | 298 | 458 | | 712 | 845 | 1133 | 1350 | 1350 | |
| 22 Force d'avance max. (intermittente) ¹ | N | | 742 | 1139 | | 1350 | 1350 | 1350 | 1350 | 1350 | |
| Numéros d'article | | | | | | | | | | | |
| 1 Rapport de réduction | | | | 23:1 | | 86:1 | 159:1 | 411:1 | 636:1 | | |
| 2 Rapport de réduction exact | | | | 576/25 | | 14976/175 | 1587/10 | 359424/875 | 79488/125 | | |
| 20 Vitesse d'avance max. ¹ | mm/s | | | 5.8 | | 1.6 | 0.8 | 0.3 | 0.2 | | |
| 21 Force d'avance max. (permanente) ¹ | N | | | 472 | | 733 | 899 | 1234 | 1350 | | |
| 22 Force d'avance max. (intermittente) ¹ | N | | | 1174 | | 1350 | 1350 | 1350 | 1350 | | |
| Numéros d'article | | | | | | | | | | | |
| 1 Rapport de réduction | | | | 28:1 | | 103:1 | 190:1 | 456:1 | 706:1 | | |
| 2 Rapport de réduction exact | | | | 136/5 | | 3588/35 | 12167/64 | 89401/196 | 158171/224 | | |
| 20 Vitesse d'avance max. ¹ | mm/s | | | 4.8 | | 1.3 | 0.7 | 0.3 | 0.2 | | |
| 21 Force d'avance max. (permanente) ¹ | N | | | 504 | | 778 | 955 | 1278 | 1350 | | |
| 22 Force d'avance max. (intermittente) ¹ | N | | | 1253 | | 1350 | 1350 | 1350 | 1350 | | |
| 4 Nombre d'étages | | 0 | 1 | 2 | 2 | 3 | 3 | 4 | 4 | 4 | |
| 7 Rendement max. - réducteur plus vis/écrou | % | 27 | 22 | 20 | 20 | 19 | 19 | 16 | 16 | 16 | |
| 8 Poids ¹ | g | 304 | 304 | 331 | 331 | 359 | 359 | 387 | 387 | 387 | |
| 9 Jeu moyen à vide | ° | 0.7 | 0.7 | 0.8 | 0.8 | 1.0 | 1.0 | 1.0 | 1.0 | 1.0 | |
| 23 Précision de positionnement mécanique ¹ | mm | 0.033 | 0.033 | 0.033 | 0.033 | 0.034 | 0.034 | 0.034 | 0.034 | 0.034 | |
| 10 Moment - réducteur plus vis/écrou ¹ | gcm ² | 43.3 | 3.0 | 0.9 | 0.9 | 0.7 | 0.7 | 0.7 | 0.7 | 0.7 | |
| 11 Longueur du réducteur L1 | mm | 51.0 | 51.0 | 57.7 | 57.7 | 64.4 | 64.4 | 71.1 | 71.1 | 71.1 | |

¹ Selon la longueur de la vis 200.8 mm (Longueur standard) ² pour réduction 1:1 = 5984 tr/min



| Construction modulaire maxon | | | | | | | | | | | |
|------------------------------|---------|----------------|---------|--|-------|-------|-------|-------|-------|-------|-------|
| + Moteur | Page | + Sensor/frein | Page | Longueur totale [mm] = Longueur du moteur + longueur du réducteur + (sensor/frein) + pièces de montage | | | | | | | |
| RE 25 | 134/136 | | | 105.6 | 105.6 | 112.3 | 112.3 | 119.0 | 119.0 | 125.7 | 125.7 |
| RE 25 | 134/136 | MR | 463 | 116.6 | 116.6 | 123.3 | 123.3 | 130.0 | 130.0 | 136.7 | 136.7 |
| RE 25 | 134/136 | Enc 22 | 468 | 119.7 | 119.7 | 126.4 | 126.4 | 133.1 | 133.1 | 139.8 | 139.8 |
| RE 25 | 134/136 | HED_5540 | 471/473 | 126.4 | 126.4 | 133.1 | 133.1 | 139.8 | 139.8 | 146.5 | 146.5 |
| RE 25 | 134/136 | DCT 22 | 480 | 127.9 | 127.9 | 134.6 | 134.6 | 141.3 | 141.3 | 148.0 | 148.0 |
| RE 25, 20 W | 135 | | | 94.1 | 94.1 | 100.8 | 100.8 | 107.5 | 107.5 | 114.2 | 114.2 |
| RE 25, 20 W | 135 | MR | 463 | 105.1 | 105.1 | 111.8 | 111.8 | 118.5 | 118.5 | 125.2 | 125.2 |
| RE 25, 20 W | 135 | HED_5540 | 471/473 | 114.9 | 114.9 | 121.6 | 121.6 | 128.3 | 128.3 | 135.0 | 135.0 |
| RE 25, 20 W | 135 | DCT 22 | 480 | 116.4 | 116.4 | 123.1 | 123.1 | 129.8 | 129.8 | 136.5 | 136.5 |
| RE 25, 20 W | 135 | AB 28 | 519 | 128.2 | 128.2 | 134.9 | 134.9 | 141.6 | 141.6 | 148.3 | 148.3 |
| RE 25, 20 W | 135 | HED_5540/AB 28 | 471/519 | 145.4 | 145.4 | 152.1 | 152.1 | 158.8 | 158.8 | 165.5 | 165.5 |
| RE 25, 20 W | 136 | AB 28 | 519 | 139.7 | 139.7 | 146.4 | 146.4 | 153.1 | 153.1 | 159.8 | 159.8 |
| RE 25, 20 W | 136 | HED_5540/AB 28 | 471/519 | 156.9 | 156.9 | 163.6 | 163.6 | 170.3 | 170.3 | 177.0 | 177.0 |
| RE 30, 60 W | 138 | | | 119.1 | 119.1 | 125.8 | 125.8 | 132.5 | 132.5 | 139.2 | 139.2 |
| RE 30, 60 W | 138 | MR | 464 | 130.5 | 130.5 | 137.2 | 137.2 | 143.9 | 143.9 | 150.6 | 150.6 |
| RE 30, 60 W | 138 | HED_5540 | 471/473 | 139.9 | 139.9 | 146.6 | 146.6 | 153.3 | 153.3 | 160.0 | 160.0 |

Réducteur GP 32 S Ø32 mm, vis métrique

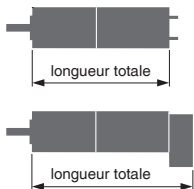

| Numéros d'article | | | | | | | | |
|-------------------|--------|--------|--------|--------|--------|--------|--------|--------|
| 363900 | 363901 | 363904 | 363909 | 363910 | 363915 | 363920 | 363925 | 363930 |
| | 363902 | 363905 | | 363911 | 363916 | 363921 | 363926 | 363931 |
| | 363903 | 363906 | | 363912 | 363917 | 363922 | 363927 | 363932 |
| | | 363907 | | 363913 | 363918 | 363923 | 363928 | |
| | | 363908 | | 363914 | 363919 | 363924 | 363929 | |

screw drive

| Construction modulaire maxon | | | | | | | | | | | | |
|------------------------------|------|-----------------|---------|--|-------|-------|-------|-------|-------|-------|-------|-------|
| + Moteur | Page | + Sensor/frein | Page | Longueur totale [mm] = longueur du moteur + longueur du réducteur + (sensor/frein) + pièces de montage | | | | | | | | |
| RE 35, 90 W | 139 | | | 122.1 | 122.1 | 128.8 | 128.8 | 135.5 | 135.5 | 142.2 | 142.2 | 142.2 |
| RE 35, 90 W | 139 | MR | 464 | 133.5 | 133.5 | 140.2 | 140.2 | 146.9 | 146.9 | 153.6 | 153.6 | 153.6 |
| RE 35, 90 W | 139 | HED_5540 | 471/473 | 142.8 | 142.8 | 149.5 | 149.5 | 156.2 | 156.2 | 162.9 | 162.9 | 162.9 |
| RE 35, 90 W | 139 | DCT 22 | 480 | 140.2 | 140.2 | 146.9 | 146.9 | 153.6 | 153.6 | 160.3 | 160.3 | 160.3 |
| RE 35, 90 W | 139 | AB 28 | 519 | 158.2 | 158.2 | 164.9 | 164.9 | 171.6 | 171.6 | 178.3 | 178.3 | 178.3 |
| RE 35, 90 W | 139 | HEDS 5540/AB 28 | 471/519 | 175.4 | 175.4 | 182.1 | 182.1 | 188.8 | 188.8 | 195.5 | 195.5 | 195.5 |
| A-max 26 | 164 | | | - | 95.8 | 102.5 | 102.5 | 109.2 | 109.2 | 115.9 | 115.9 | 115.9 |
| A-max 26 | 164 | MR | 463 | - | 104.6 | 111.3 | 111.3 | 118.0 | 118.0 | 124.7 | 124.7 | 124.7 |
| A-max 26 | 164 | Enc 22 | 468 | - | 110.2 | 116.9 | 116.9 | 123.6 | 123.6 | 130.3 | 130.3 | 130.3 |
| A-max 26 | 164 | HED_5540 | 472/474 | - | 114.2 | 120.9 | 120.9 | 127.6 | 127.6 | 134.3 | 134.3 | 134.3 |
| A-max 32 | 165 | | | - | 114.0 | 120.7 | 120.7 | 127.4 | 127.4 | 134.1 | 134.1 | 134.1 |
| A-max 32 | 166 | | | - | 112.6 | 119.3 | 119.3 | 126.0 | 126.0 | 132.7 | 132.7 | 132.7 |
| A-max 32 | 166 | MR | 464 | - | 123.8 | 130.5 | 130.5 | 137.2 | 137.2 | 143.9 | 143.9 | 143.9 |
| A-max 32 | 166 | HED_5540 | 471/473 | - | 133.4 | 140.1 | 140.1 | 146.8 | 146.8 | 153.5 | 153.5 | 153.5 |
| EC 32, 80 W | 228 | | | 111.1 | 111.1 | 117.8 | 117.8 | 124.5 | 124.5 | 131.2 | 131.2 | 131.2 |
| EC 32, 80 W | 228 | HED_5540 | 471/473 | 129.5 | 129.5 | 136.2 | 136.2 | 142.9 | 142.9 | 149.6 | 149.6 | 149.6 |
| EC 32, 80 W | 228 | Res 26 | 481 | 131.2 | 131.2 | 137.9 | 137.9 | 144.6 | 144.6 | 151.3 | 151.3 | 151.3 |
| EC-max 22, 25 W | 239 | | | - | 99.6 | 106.3 | 106.3 | 113.0 | 113.0 | 119.7 | 119.7 | 119.7 |
| EC-max 22, 25 W | 239 | MR | 464 | - | 109.2 | 115.9 | 115.9 | 122.6 | 122.6 | 129.3 | 129.3 | 129.3 |
| EC-max 22, 25 W | 239 | AB 20 | 516 | - | 135.2 | 141.9 | 141.9 | 148.6 | 148.6 | 155.3 | 155.3 | 155.3 |
| EC-max 30, 40 W | 240 | | | - | 93.1 | 99.8 | 99.8 | 106.5 | 106.5 | 113.2 | 113.2 | 113.2 |
| EC-max 30, 40 W | 240 | MR | 464 | - | 105.3 | 112.0 | 112.0 | 118.7 | 118.7 | 125.4 | 125.4 | 125.4 |
| EC-max 30, 40 W | 240 | HEDL 5540 | 474 | - | 113.7 | 120.4 | 120.4 | 127.1 | 127.1 | 133.8 | 133.8 | 133.8 |
| EC-max 30, 40 W | 240 | AB 20 | 516 | - | 128.7 | 135.4 | 135.4 | 142.1 | 142.1 | 148.8 | 148.8 | 148.8 |
| EC-max 30, 40 W | 240 | HEDL 5540/AB 20 | 474/516 | - | 149.3 | 156.0 | 156.0 | 162.7 | 162.7 | 169.4 | 169.4 | 169.4 |
| EC-4pole 22, 90 W | 247 | | | 99.7 | 99.7 | 106.4 | 106.4 | 113.1 | 113.1 | 119.8 | 119.8 | 119.8 |
| EC-4pole 22, 90 W | 247 | 16 EASY/XT/Abs. | 449-453 | 111.9 | 111.9 | 118.6 | 118.6 | 125.3 | 125.3 | 132.0 | 132.0 | 132.0 |
| EC-4pole 22, 90 W | 247 | 16 EASY Abs. XT | 455 | 112.4 | 112.4 | 119.1 | 119.1 | 125.8 | 125.8 | 132.5 | 132.5 | 132.5 |
| EC-4pole 22, 90 W | 247 | 16 RIO | 466 | 110.4 | 110.4 | 117.1 | 117.1 | 123.8 | 123.8 | 130.5 | 130.5 | 130.5 |
| EC-4pole 22, 90 W | 247 | AEDL/HEDL | 469/475 | 121.2 | 121.2 | 127.9 | 127.9 | 134.6 | 134.6 | 141.3 | 141.3 | 141.3 |
| EC-4pole 22,120 W | 248 | | | 117.1 | 117.1 | 123.8 | 123.8 | 130.5 | 130.5 | 137.2 | 137.2 | 137.2 |
| EC-4pole 22,120 W | 248 | 16 EASY/XT/Abs. | 449-453 | 129.3 | 129.3 | 136.0 | 136.0 | 142.7 | 142.7 | 149.4 | 149.4 | 149.4 |
| EC-4pole 22,120 W | 248 | 16 EASY Abs. XT | 455 | 129.8 | 129.8 | 136.5 | 136.5 | 143.2 | 143.2 | 149.9 | 149.9 | 149.9 |
| EC-4pole 22,120 W | 248 | 16 RIO | 466 | 127.8 | 127.8 | 134.5 | 134.5 | 141.2 | 141.2 | 147.9 | 147.9 | 147.9 |
| EC-4pole 22,120 W | 248 | AEDL/HEDL | 469/475 | 138.6 | 138.6 | 145.3 | 145.3 | 152.0 | 152.0 | 158.7 | 158.7 | 158.7 |
| EC-i 30, 30 W | 258 | | | 93.3 | 93.3 | 100.0 | 100.0 | 106.7 | 106.7 | 113.4 | 113.4 | 113.4 |
| EC-i 30, 30 W | 258 | 16 EASY/Abs. | 449/453 | 105.0 | 105.0 | 111.7 | 111.7 | 118.4 | 118.4 | 125.1 | 125.1 | 125.1 |
| EC-i 30, 30 W | 258 | 16 RIO | 466 | 103.5 | 103.5 | 110.2 | 110.2 | 116.9 | 116.9 | 123.6 | 123.6 | 123.6 |
| EC-i 30, 30 W | 258 | AEDL/HEDL | 469/474 | 114.0 | 114.0 | 120.7 | 120.7 | 127.4 | 127.4 | 134.1 | 134.1 | 134.1 |
| EC-i 30, 45 W | 259 | | | 93.3 | 93.3 | 100.0 | 100.0 | 106.7 | 106.7 | 113.4 | 113.4 | 113.4 |
| EC-i 30, 45 W | 259 | 16 EASY/Abs. | 449/453 | 105.0 | 105.0 | 111.7 | 111.7 | 118.4 | 118.4 | 125.1 | 125.1 | 125.1 |
| EC-i 30, 45 W | 259 | 16 RIO | 466 | 103.5 | 103.5 | 110.2 | 110.2 | 116.9 | 116.9 | 123.6 | 123.6 | 123.6 |
| EC-i 30, 45 W | 259 | AEDL/HEDL | 469/474 | 114.0 | 114.0 | 120.7 | 120.7 | 127.4 | 127.4 | 134.1 | 134.1 | 134.1 |
| EC-i 30, 50 W | 260 | | | 115.3 | 115.3 | 122.0 | 122.0 | 128.7 | 128.7 | 135.4 | 135.4 | 135.4 |
| EC-i 30, 50 W | 260 | 16 EASY/Abs. | 449/453 | 127.0 | 127.0 | 133.7 | 133.7 | 140.4 | 140.4 | 147.1 | 147.1 | 147.1 |
| EC-i 30, 50 W | 260 | 16 RIO | 466 | 125.5 | 125.5 | 132.2 | 132.2 | 138.9 | 138.9 | 145.6 | 145.6 | 145.6 |
| EC-i 30, 50 W | 260 | AEDL/HEDL | 469/474 | 136.0 | 136.0 | 142.7 | 142.7 | 149.4 | 149.4 | 156.1 | 156.1 | 156.1 |
| EC-i 30, 75 W | 261 | | | 115.3 | 115.3 | 122.0 | 122.0 | 128.7 | 128.7 | 135.4 | 135.4 | 135.4 |
| EC-i 30, 75 W | 261 | 16 EASY/Abs. | 449/453 | 127.0 | 127.0 | 133.7 | 133.7 | 140.4 | 140.4 | 147.1 | 147.1 | 147.1 |
| EC-i 30, 75 W | 261 | 16 RIO | 466 | 125.5 | 125.5 | 132.2 | 132.2 | 138.9 | 138.9 | 145.6 | 145.6 | 145.6 |
| EC-i 30, 75 W | 261 | AEDL/HEDL | 469/474 | 136.0 | 136.0 | 142.7 | 142.7 | 149.4 | 149.4 | 156.1 | 156.1 | 156.1 |
| EC-i 40, 50 W | 262 | | | 82.7 | 82.7 | 89.4 | 89.4 | 96.1 | 96.1 | 102.8 | 102.8 | 102.8 |
| EC-i 40, 50 W | 262 | 16 EASY/Abs. | 449/453 | 94.4 | 94.4 | 101.1 | 101.1 | 107.8 | 107.8 | 114.5 | 114.5 | 114.5 |
| EC-i 40, 50 W | 262 | 16 RIO | 466 | 97.2 | 97.2 | 103.9 | 103.9 | 110.6 | 110.6 | 117.3 | 117.3 | 117.3 |
| EC-i 40, 50 W | 262 | AEDL/HEDL | 469/474 | 105.7 | 105.7 | 112.4 | 112.4 | 119.1 | 119.1 | 125.8 | 125.8 | 125.8 |
| EC-i 40, 70 W | 264 | | | 92.7 | 92.7 | 99.4 | 99.4 | 106.1 | 106.1 | 112.8 | 112.8 | 112.8 |
| EC-i 40, 70 W | 264 | 16 EASY/Abs. | 449/453 | 104.4 | 104.4 | 111.1 | 111.1 | 117.8 | 117.8 | 124.5 | 124.5 | 124.5 |
| EC-i 40, 70 W | 264 | 16 RIO | 466 | 107.2 | 107.2 | 113.9 | 113.9 | 120.6 | 120.6 | 127.3 | 127.3 | 127.3 |
| EC-i 40, 70 W | 264 | AEDL/HEDL | 469/474 | 115.7 | 115.7 | 122.4 | 122.4 | 129.1 | 129.1 | 135.8 | 135.8 | 135.8 |